

## **Warranty Clauses**

### CARDIO LINE 400/400 MED

Warranty .....	2
Care and maintenance.....	4
Cleaning.. ..	6

## Warranty clauses

Warranty of 2 years (see general terms and conditions, point 8.1 guarantee „ERGO-FIT grants 2 years guarantee for its own products. In the first year the travel expenses and occurring working hours within Germany are borne in addition to the spare parts. In the second year only the spare parts. For merchandise the guarantee provisions of the respective manufacturer apply accordingly“)

The seller shall be liable, to the exclusion of other liability, for deficiencies of the delivery, of which the absence of expressly affirmed properties is part, as follows:

1. All parts that are found to be unusable or restricted in use in consequence of a circumstance dated before the transfer of risk - notably because of faulty design, bad manufacturing material or faulty workmanship - shall be repaired or replaced during a period of 24 months after delivery. The decision if the fault will be repaired or should be replaced will be at the seller's discretion. The supplier shall only be liable for deficiencies of drawings and materials delivered or chosen by the seller if he would have been able to recognise the deficiency when applying professional accuracy unless the seller notified the purchaser of the recognised deficiency immediately.
2. The purchaser's right to claim ends in all cases after 24 months after transfer of the object.
3. No guarantee shall be assumed for damage as a result of inappropriate or improper use, faulty assembly or faulty startup carried out by the purchaser or a third party, natural wear, faulty or careless handling, inappropriate equipment or exchange work material, faulty construction works, chemical, electrochemical or electric influences, except in the event that they can be traced to the fault of the seller. The purchaser will assume all risks in connection with the delivery, even in case of free freight ex-factory.
4. Initially, the seller has the right to two rectifications or replacements. Should these fail, the purchaser has the right of abatement or rescission within the scope of valid legislation. The seller will have a period of six weeks as from communicating the notice of defect for rectification.
5. Improper modifications or repairs carried out on behalf of the purchaser or a third party without prior permission of the seller will abrogate warranty claims.
6. If goods are exported, warranty will be restricted to the availability of loose spare parts ex-factory within the warranty period. Packing costs, freight charge and labour will be at the expense of the purchaser. In case the purchaser demands on-site repair by a technician of the factory or another service address, the purchaser will assume the costs of travelling expenses and labour.
7. All merchandise that has not been produced by the seller is subject to legal provisions.

Wear parts are excluded from warranty specifications, e.g.:

- ⊗ pedal string
- ⊗ handle bar tube
- ⊗ seat
- ⊗ toothed belt
- ⊗ chains
- ⊗ lever to fasten the handle bar
- ⊗ pedals
- ⊗ seat, tread, handle bars
- ⊗ fuses
- ⊗ freewheel
- ⊗ SPO<sub>2</sub> module

The warranty is voided if maintenance instructions are not observed!

## Maintenance

All exercise machines used for commercial purposes need to undergo regular a safety inspection/maintenance test.

Regular, thorough care and appropriate maintenance in particular contribute to preserve the value and lifetime of your exercise machine. For this reason, we recommend regular preventive maintenance. Once per week, inspect the casing, seat and its guiding, handlebar and pedals for damage. In case of a damage, have it repaired immediately. These regular inspections are essential for compliance in case of guarantee claims. In case of a malfunction, ERGO-FIT's technicians and engineers are pleased to assist you.



Before switching on the machines, always make sure that mains cable, mains plug, mains socket and power connection units are free from defects.

### Immediate maintenance works are to be carried out if:

- ⊗ the machine has undergone extreme mechanical stress (impact, damaged cable, or inappropriate tensile strain),
- ⊗ liquid has entered the machine,
- ⊗ cables, plug-in connectors or casings are damaged,
- ⊗ covers have dropped.

Maintenance of the machine may be carried out by ERGO-FIT's customer service department. A maintenance contract may be concluded also.

## Care and maintenance

During manufacturing of its training machines, ERGO-FIT makes every effort to reduce future maintenance.

In the following chapters, some of the maintenance and verifications are described. You should carry out these tasks regularly.



Switch off and unplug the machine before any maintenance is carried out or the machine is opened.

When carrying out maintenance, consider the following:

- ⊗ This machine requires very little maintenance.
- ⊗ Moving parts need no further oiling or greasing.
- ⊗ Once per week, inspect the seat, the handlebar, the pedals, and the casing for damage. If the machine is damaged, have it repaired immediately

**Treadle**

- ⊗ As screws tend to loosen over time, you should check the treadles and pedals after 3 to 5 operational hours for the first time, then every month. Note that the left pedal has a left-handed thread and the right pedal has a right handed thread.
- ⊗ If a treadle loosens, screw it on again tightly immediately. To do this, remove the black cap from the crankshaft and retighten the screw underneath with a 14 mm (1/4 inch) socket wrench. The pedal can be retightened to the crankshaft with a 15 mm open-end wrench.

**SPO<sub>2</sub>-module**

- ⊗ This module is almost maintenance-free.

**Seat**

- ⊗ Make sure that the stop bolt is underneath the seat post and that it is screwed in tightly. If the stop bolt is damaged or missing, the unit must be taken out of service and repaired by qualified personnel. Otherwise there is a risk of injury.

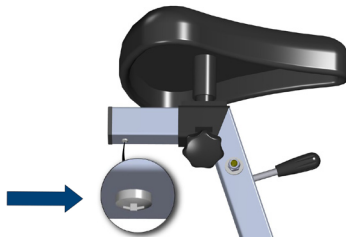

## Cleaning

Sweat, dust particles and dirt will damage your exercise machine. This can be observed after only a few weeks. Metal and aluminium parts of your machine may alter its surfaces in combination with sweat. For this reason, you should clean your machine daily.

To clean your exercise machine we recommend disinfectant „Ecolab P3-steril“ or „Scarabig“. This product is available at:

Ecolab Deutschland GmbH  
Reisholzer Werftstraße 38-42  
Postfach 13 04 06  
D-40554 Düsseldorf  
www.ecolab.com

SCARAPHARM chem.-pharm. Produkte GmbH  
Wachmannstraße 86  
D-28209 Bremen  
www.scarapharm.de

### During cleaning, consider the following aspects:

- ⊗ Make sure to disconnect the mains plug before cleaning your machine.
- ⊗ Clean your machine with a damp cloth, mild cleaning agent or soap suds only and dry it with a soft cloth.
- ⊗ Avoid any oiling or greasing of the machine's outside.

### Cleaning the SPO<sub>2</sub> Clip:

Before cleaning the SPO<sub>2</sub> module disconnect the connectors at the control panel.

- ⊗ Clean the sensor with a soft, damp cloth and a mild detergent. The manufacturer recommends Klenzyme by Steris Corporation.
- ⊗ Do not use aggressive disinfectants. Sensors can be damaged. The manufacturer recommends isopropanol (70%) or high level disinfection with CIDEX OPA by Johnson and Johnson Corporation.